



Elvod
SINCE 1957 Kragujevac

POKLOPCI I OBUJMICE





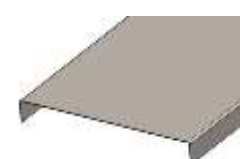

Poklopci i obujmice

	Poklopac					Cover		
	Tip Type	Širina Width (mm)	Dužina Length (mm)	Visina Height (mm)	Debljina lima Thickness (mm)		Kataloški broj Catalog N°	
					2m	3m	2m	3m
	PK-50	50	2000/3000	20	0,6	0,8	06.210.100	06.210.100.3
PK-100	100	2000/3000	20	0,6	0,8	06.200.100	06.200.100.3	
PK-160	160	2000/3000	20	0,6	0,8	06.220.100	06.220.100.3	
PK-200	200	2000/3000	20	0,6	0,8	06.230.100	06.230.100.3	
PK-220	220	2000/3000	20	0,6	0,8	06.240.100	06.240.100.3	
PK-300	300	2000/3000	20	0,8		06.260.100	06.260.100.3	
PK-400	400	2000/3000	20	0,8		06.270.100	06.270.100.3	
PK-500	500	2000/3000	20	0,8		06.280.100	06.280.100.3	
PK-600	600	2000/3000	20	0,8		06.290.100	06.290.100.3	



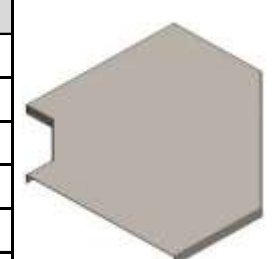

Poklopac ugaone spojnice 90°					Cover angle connectors 90°	
	Tip Type	Širina Width (mm)	Visina Height (mm)	Debljina lima Thickness (mm)	Kataloški broj Catalog N°	
	PKSL-II-50	50	20	0,8	06.250.000	
	PKSL-II-100	100	20		06.250.001	
	PKSL-II-160	160	20		06.250.003	
	PKSL-II-200	200	20		06.250.004	
	PKSL-II-220	220	20		06.250.005	
	PKSL-II-300	300	20		06.250.006	
	PKSL-II-400	400	20		06.250.007	
	PKSL-II-500	500	20		06.250.008	
	PKSL-II-600	600	20		06.250.009	



Poklopac ugaone spojnice 45°					Cover angle connectors 45°	
	Tip Type	Širina Width (mm)	Visina Height (mm)	Debljina lima Thickness (mm)	Kataloški broj Catalog N°	
	PKSY-II-50	50	20	0,8	06.250.010	
	PKSY-II-100	100	20		06.250.011	
	PKSY-II-160	160	20		06.250.012	
	PKSY-II-200	200	20		06.250.013	
	PKSY-II-220	220	20		06.250.014	
	PKSY-II-300	300	20		06.250.015	
	PKSY-II-400	400	20		06.250.016	
	PKSY-II-500	500	20		06.250.017	
	PKSY-II-600	600	20		06.250.018	



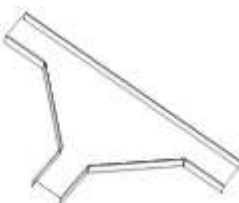
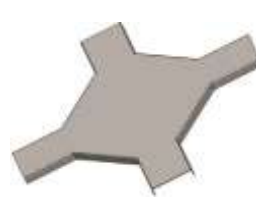

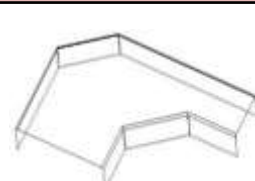
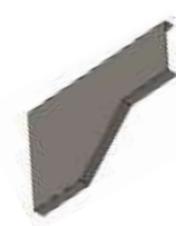
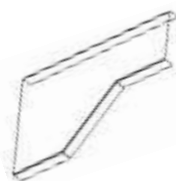
Poklopac račvaste spojnice		Cover of T connector				
	Tip Type	Širina Width (mm)	Visina Height (mm)	Debljina lima Thickness (mm)	Kataloški broj Catalog N°	
	PKS-III-50	50	20	0,8	06.250.019	
	PKS-III-100	100	20		06.250.020	
	PKS-III-160	160	20		06.250.021	
	PKS-III-200	200	20		06.250.022	
	PKS-III-220	220	20		06.250.023	
	PKS-III-300	300	20		06.250.024	
	PKS-III-400	400	20		06.250.025	
	PKS-III-500	500	20		06.250.026	
	PKS-III-600	600	20		06.250.027	
Poklopac krstaste spojnice		Cover of cross connector				
	Tip Type	Širina Width (mm)	Visina Height (mm)	Debljina lima Thickness (mm)	Kataloški broj Catalog N°	
	PKS-IV-50	50	20	0,8	06.250.028	
	PKS-IV-100	100	20		06.250.029	
	PKS-IV-160	160	20		06.250.030	
	PKS-IV-200	200	20		06.250.031	
	PKS-IV-220	220	20		06.250.032	
	PKS-IV-300	300	20		06.250.033	
	PKS-IV-400	400	20		06.250.034	
	PKS-IV-500	500	20		06.250.035	
	PKS-IV-600	600	20		06.250.036	
Poklopac reducir ugaona 90° spojnica		Cover for reduction angle 90° connector				
	Tip Type	Visina Height (mm)	Širina redukcije Reduction width (mm)	Debljina lima Thickness (mm)	Kataloški broj Catalog N°	
	PKRS50-III	20	50	0,8	06.250.056	
	PKRS100-III	20	100		06.250.057	
Poklopac za desnu reducir spojnicu		Cover for right reduction connector				
	Tip Type	Visina Height (mm)	Širina redukcije Reduction width (mm)	Debljina lima Thickness (mm)	Kataloški broj Catalog N°	
	PKRD 50-IV	20	50	0,8	06.250.058	
	PKRD 100-IV	20	100		06.250.059	



Poklopac za levu reducir spojnicu		Cover for right reduction connector				
	Tip Type	Visina Height (mm)	Širina redukcije Reduction width (mm)	Debljina lima Thickness (mm)	Kataloški broj Catalog N°	
	PKRL 50-IV	20	50	0,8	06.250.068	
	PKRL 100-IV	20	100		06.250.069	

Poklopac vertikalne uzlazne spojnice		Cover of vertical up connector				
	Tip Type	Širina Width (mm)	Visina Height (mm)	Debljina lima Thickness (mm)	Kataloški broj Catalog N°	
	PKS-I-50u	50	20	0,8	06.250.037	
	PKS-I-100u	100	20		06.250.038	
	PKS-I-160u	160	20		06.250.039	
	PKS-I-200u	200	20		06.250.040	
	PKS-I-220u	220	20		06.250.041	
	PKS-I-300u	300	20		06.250.042	
	PKS-I-400u	400	20		06.250.043	
	PKS-I-500u	500	20		06.250.044	
	PKS-I-600u	600	20		06.250.045	

Poklopac vertikalne silazne spojnice		Cover of vertical down connector				
	Tip Type	Širina Width (mm)	Visina Height (mm)	Debljina lima Thickness (mm)	Kataloški broj Catalog N°	
	PKS-I-50s	50	20	0,8	06.250.046	
	PKS-I-100s	100	20		06.250.047	
	PKS-I-160s	160	20		06.250.048	
	PKS-I-200s	200	20		06.250.049	
	PKS-I-220s	220	20		06.250.051	
	PKS-I-300s	300	20		06.250.052	
	PKS-I-400s	400	20		06.250.053	
	PKS-I-500s	500	20		06.250.054	
	PKS-I-600s	600	20		06.250.055	



Obujmica za poklopac Clip clamp									
Tip Type	H 30			H 48			H 50		
	Širina Width (mm)	Debljina lima Thickness (mm)	Kataloški broj Catalog N°	Širina Width (mm)	Debljina lima Thickness (mm)	Kataloški broj Catalog N°	Širina Width (mm)	Debljina lima Thickness (mm)	Kataloški broj Catalog N°
OB-50	50	0,8	06.210.100.1	50	0,8	06.210.101.1			
OB-100	100	0,8	06.200.100.1				100	0,8	06.200.101.1
OB-160	160	0,8	06.220.100.1				160	0,8	06.220.101.1
OB-200	200	0,8	06.230.100.1				200	0,8	06.230.101.1
OB-220	220	0,8	06.240.100.1				220	0,8	06.240.101.1
OB-300							300	1	06.260.100.1
OB-400							400	1	06.270.100.1
OB-500							500	1,5	06.280.100.1
OB-600							600	1,5	06.290.100.1
Tip Type	H 60			H 85			H 110		
	Širina Width (mm)	Debljina lima Thickness (mm)	Kataloški broj Catalog N°	Širina Width (mm)	Debljina lima Thickness (mm)	Kataloški broj Catalog N°	Širina Width (mm)	Debljina lima Thickness (mm)	Kataloški broj Catalog N°
OB-50									
OB-100	100	0,8	06.200.102.1	100	0,8	06.200.103.1	100	0,8	06.200.104.1
OB-160	160	0,8	06.220.102.1	160	0,8	06.220.103.1			
OB-200	200	0,8	06.230.102.1	200	0,8	06.230.103.1	200	0,8	06.230.104.1
OB-220	220	0,8	06.240.102.1	220	0,8	06.240.103.1			
OB-300	300	1	06.260.101.1	300	1	06.260.102.1	300	1	06.260.103.1
OB-400	400	1	06.270.101.1	400	1	06.270.102.1	400	1	06.270.103.1
OB-500	500	1,5	06.280.101.1	500	1,5	06.280.102.1	500	1,5	06.280.103.1
OB-600	600	1,5	06.290.101.1	600	1,5	06.290.102.1			

Odlivni lim Drainage sheet						
Tip Type	Širina Width (mm)	Visina Height (mm)	Dužina Length (mm)	Debljina lima Thickness (mm)	Kataloški broj Catalog N°	
OL-100	110	70	80	1,5	09.000.001	
OL-160	110	70	140	1,5	09.000.016	
OL-200	110	70	180	1,5	09.000.002.1	
OL-220	110	70	200	1,5	09.000.022	
OL-300	110	70	280	1,5	09.000.003.1	
OL-400	110	70	380	1,5	09.000.220	
OL-500	110	70	480	1,5	09.000.218	
OL-600	110	70	580	1,5	09.000.221	

Stezač poklopca za PNK PNK cover clips					
Tip Type	Širina Width (mm)	Visina Height (mm)	Debljina lima Thickness (mm)	Kataloški broj Catalog N°	
ZA-PNK 30	30	35	2	06.001.030	
ZA-PNK 35	30	40	2	06.001.035	
ZA-PNK 40	30	45	2	06.001.040	
ZA-PNK 48/50	30	55	2	06.001.050	
ZA-PNK 60	30	65	2	06.001.060	
ZA-PNK 85	30	90	2	06.001.085	
ZA-PNK 90	30	95	2	06.001.090	
ZA-PNK 100	30	105	2	06.001.100	
ZA-PNK 110	30	115	2	06.001.110	

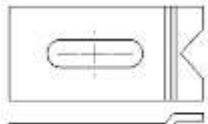

	Stezna pločica			Clamp plate
	Tip Type	Debljina lima Thickness (mm)		Kataloški broj Catalog N°
	SP	2		06.420.119

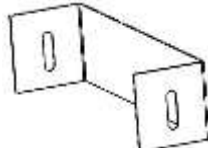

	Krajnji poklopac								Ending cover
	Tip Type	H 30		H 35		H 40		H 48	
		Širina Width (mm)	Kataloški broj Catalog N°	Širina Width (mm)	Kataloški broj Catalog N°	Širina Width (mm)	Kataloški broj Catalog N°	Širina Width (mm)	Kataloški broj Catalog N°
KP-50	50	06.001.000			50	06.001.0011	50	06.001.018	
KP-100	100	06.001.001	100	06.001.005	100	06.001.012			
KP-160	160	06.001.002							
KP-200	200	06.001.003	200	06.001.006	200	06.001.013			
KP-220	220	06.001.004							
KP-300			300	06.001.007	300	06.001.014			
KP-400			400	06.001.008	400	06.001.015			
KP-500			500	06.001.009	500	06.001.016			
KP-600			600	06.001.010	600	06.001.017			
Tip Type	H 50		H 60		H 85		H 90		
	Širina Width (mm)	Kataloški broj Catalog N°	Širina Width (mm)	Kataloški broj Catalog N°	Širina Width (mm)	Kataloški broj Catalog N°	Širina Width (mm)	Kataloški broj Catalog N°	
KP-50									
KP-100	100	06.001.019	100	06.001.025	100	06.001.031	100	06.001.039	
KP-160					160	06.001.032			
KP-200	200	06.001.020	200	06.001.026	200	06.001.033	200	06.001.040	
KP-220					220	06.001.034			
KP-300	300	06.001.021	300	06.001.027	300	06.001.035	300	06.001.041	
KP-400	400	06.001.022	400	06.001.028	400	06.001.036			
KP-500	500	06.001.023	500	06.001.029	500	06.001.037			
KP-600	600	06.001.024	600	06.001.030	600	06.001.038			
Tip Type	H 100		H 110						
	Širina Width (mm)	Kataloški broj Catalog N°	Širina Width (mm)	Kataloški broj Catalog N°					
KP-50									
KP-100	100	06.001.042	100	06.001.045					
KP-160									
KP-200	200	06.001.043	200	06.001.046					
KP-220									
KP-300	300	06.001.044	300	06.001.047					
KP-400			400	06.001.048					
KP-500			500	06.001.049					
KP-600			600	06.001.050					

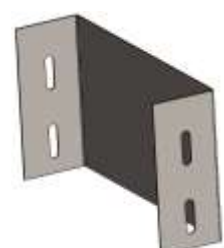

Za sve poklopce obezbedili smo različite oblike površinske zaštite prikazane u tabeli ispod
For all covers we have provided various shapes of protection surfaces shown in the table below

Površinska zaštita Surface protection	Oznaka Mark	Oblast primene Field of application	STANDARD
Galvanizacija cinkom Galvanized sheet	PL	Unutrašnja oblast Internal area	EN 10142
Topla galvanizacija cinkom Hot dip galvanized	TC	Spoljna oblast External field	SRPS EN ISO 1461
Plastifikacija u RAL boje Plastification in RAL	P	Unutrašnja oblast Internal area	
Nerdajući čelik Inox	I	Specijalni industrijski zahtevi, prehrambena industrija, farmacija, hemijska industrija itd. Special industrial requirements, food industry, pharmacy, chemical industry, etc.	V2A, V4A



Završno sedlo		Final saddle									
		H 50				H 60					
		Tip Type	Širina Width (mm)	Debljina lima Thickness (mm)	Poluprečnik Radius (mm)	Kataloški broj Catalog N°	Tip Type	Širina Width (mm)	Debljina lima Thickness (mm)	Poluprečni k Radius (mm)	Kataloški broj Catalog N°
ZS-100	100	2	90	09.100.095	ZS-100	100	2	90	09.100.096		
ZS-100	100	2	250	09.100.255	ZS-100	100	2	250	09.100.256		
ZS-160	160	2	90	09.160.095	ZS-160	160	2	90	09.160.096		
ZS-160	160	2	250	09.160.255	ZS-160	160	2	250	09.160.256		
ZS-200	200	2	90	09.200.095	ZS-200	200	2	90	09.200.096		
ZS-200	200	2	250	09.200.255	ZS-200	200	2	250	09.200.256		
ZS-220	220	2	90	09.220.095	ZS-220	220	2	90	09.220.096		
ZS-220	220	2	250	09.220.255	ZS-220	220	2	250	09.220.256		
ZS-300	300	2	90	09.300.095	ZS-300	300	2	90	09.300.096		
ZS-300	300	2	250	09.300.255	ZS-300	300	2	250	09.300.256		
ZS-400	400	2	90	09.400.095	ZS-400	400	2	90	09.400.096		
ZS-400	400	2	250	09.400.255	ZS-400	400	2	250	09.400.256		
ZS-500	500	2	90	09.500.095	ZS-500	500	2	90	09.500.096		
ZS-500	500	2	250	09.500.255	ZS-500	500	2	250	09.500.256		
ZS-600	600	2	90	09.600.095	ZS-600	600	2	90	09.600.096		
ZS-600	600	2	250	09.600.255	ZS-600	600	2	250	09.600.256		
		H 85				H 90					
		Tip Type	Širina Width (mm)	Debljina lima Thickness (mm)	Poluprečnik Radius (mm)	Kataloški broj Catalog N°	Tip Type	Širina Width (mm)	Debljina lima Thickness (mm)	Poluprečni k Radius (mm)	Kataloški broj Catalog N°
		ZS-100	100	2	90	09.100.098	ZS-100	100	2	90	09.100.099
ZS-100	100	2	250	09.100.258	ZS-100	100	2	250	09.100.259		
ZS-160	160	2	90	09.160.098	ZS-160	160	2	90	09.160.099		
ZS-160	160	2	250	09.160.258	ZS-160	160	2	250	09.160.259		
ZS-200	200	2	90	09.200.098	ZS-200	200	2	90	09.200.099		
ZS-200	200	2	250	09.200.258	ZS-200	200	2	250	09.200.259		
ZS-220	220	2	90	09.220.098	ZS-220	220	2	90	09.220.099		
ZS-220	220	2	250	09.220.258	ZS-220	220	2	250	09.220.259		
ZS-300	300	2	90	09.300.098	ZS-300	300	2	90	09.300.099		
ZS-300	300	2	250	09.300.258	ZS-300	300	2	250	09.300.259		
ZS-400	400	2	90	09.400.098	ZS-400	400	2	90	09.400.099		
ZS-400	400	2	250	09.400.258	ZS-400	400	2	250	09.400.259		
ZS-500	500	2	90	09.500.098	ZS-500	500	2	90	09.500.099		
ZS-500	500	2	250	09.500.258	ZS-500	500	2	250	09.500.259		
ZS-600	600	2	90	09.600.098	ZS-600	600	2	90	09.600.099		
ZS-600	600	2	250	09.600.258	ZS-600	600	2	250	09.600.259		
		H 100				H 110					
		Tip Type	Širina Width (mm)	Debljina lima Thickness (mm)	Poluprečnik Radius (mm)	Kataloški broj Catalog N°	Tip Type	Širina Width (mm)	Debljina lima Thickness (mm)	Poluprečni k Radius (mm)	Kataloški broj Catalog N°
		ZS-100	100	2	90	09.100.090	ZS-100	100	2	90	09.100.091
ZS-100	100	2	250	09.100.250	ZS-100	100	2	250	09.100.251		
ZS-160	160	2	90	09.160.090	ZS-160	160	2	90	09.160.091		
ZS-160	160	2	250	09.160.250	ZS-160	160	2	250	09.160.251		
ZS-200	200	2	90	09.200.090	ZS-200	200	2	90	09.200.091		
ZS-200	200	2	250	09.200.250	ZS-200	200	2	250	09.200.251		
ZS-220	220	2	90	09.220.090	ZS-220	220	2	90	09.220.091		
ZS-220	220	2	250	09.220.250	ZS-220	220	2	250	09.220.251		
ZS-300	300	2	90	09.300.090	ZS-300	300	2	90	09.300.091		
ZS-300	300	2	250	09.300.250	ZS-300	300	2	250	09.300.251		
ZS-400	400	2	90	09.400.090	ZS-400	400	2	90	09.400.091		
ZS-400	400	2	250	09.400.250	ZS-400	400	2	250	09.400.251		
ZS-500	500	2	90	09.500.090	ZS-500	500	2	90	09.500.091		
ZS-500	500	2	250	09.500.250	ZS-500	500	2	250	09.500.251		
ZS-600	600	2	90	09.600.090	ZS-600	600	2	90	09.600.091		
ZS-600	600	2	250	09.600.250	ZS-600	600	2	250	09.600.251		



Zbog procesa varenja pri izradi završnog sedla , ovaj element se naručuje i isporučuje u dve varijante koje su date u tabeli ispod

Due to the process of welding in the final saddle production, this element is ordered and delivered in two variants given in the table below

Površinska zaštita Surface protection	Oznaka Mark	Oblast primene Field of application	STANDARD
Topla galvanizacija cinkom Hot dip galvanized	TC	Spoljna oblast External field	SRPS EN ISO 1461
Plastifikacija u RAL boje Plastification in RAL	P	Unutrašnja oblast Internal area	

